

Area

How to create areas with Smart Jobsite For Revit

Areas such as Delivery, Storage or Pickup can be created and manage thanks to Smart Jobsite. When you create task you can define the areas for the beginning and the end of the task. Smart Jobsite will then calculate the task time.

To create an are Smart Jobsite will use a floor. Once a floor is defined as an area for Smart Jobsite it will not take into account anymore as an element to lift

To create a floor you can use the Revit tools under Architecture/floor

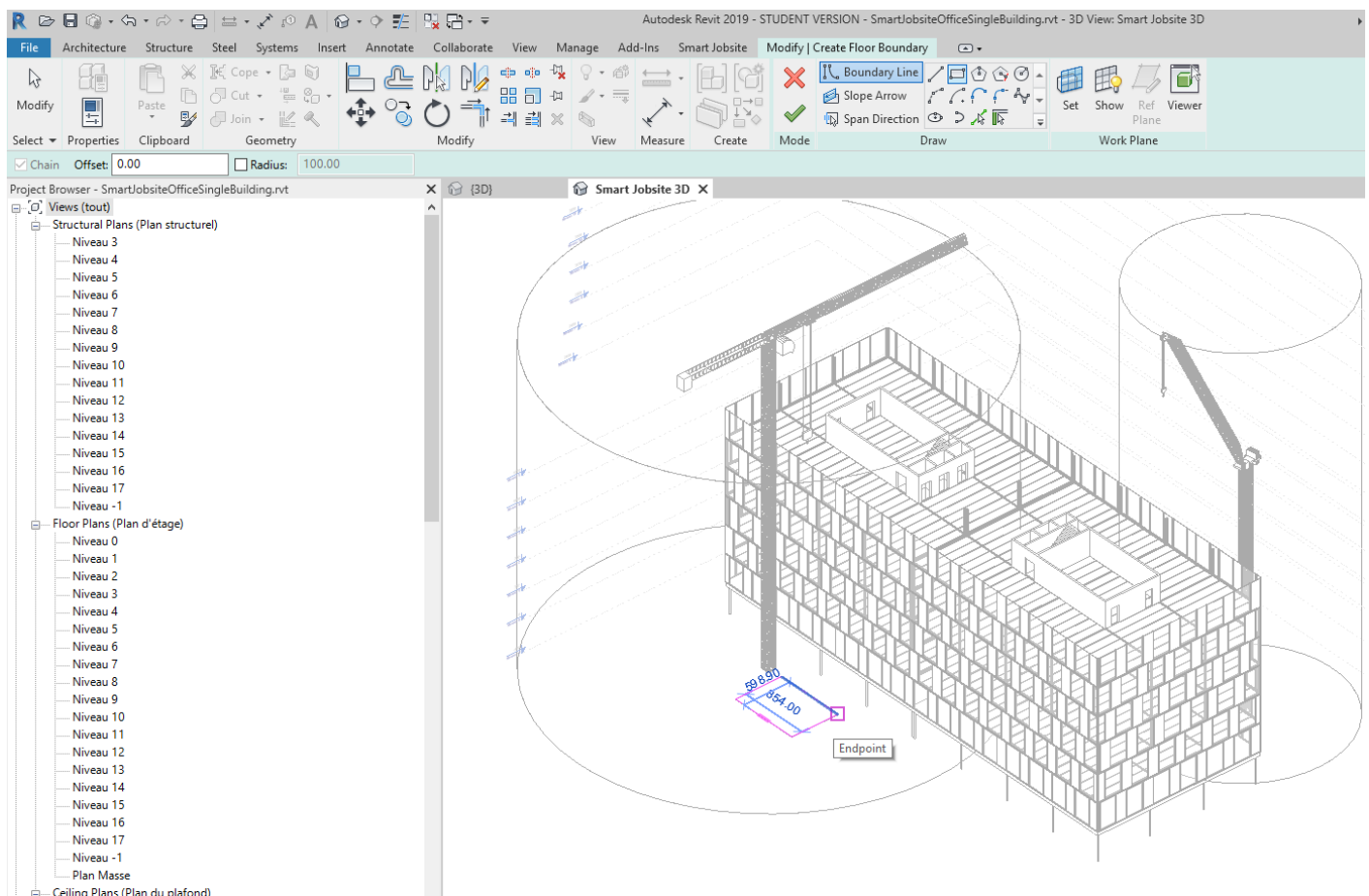

you can draw your floor and validate

Then under the Smart Jobsite tab you can click on the Area button to create an Area

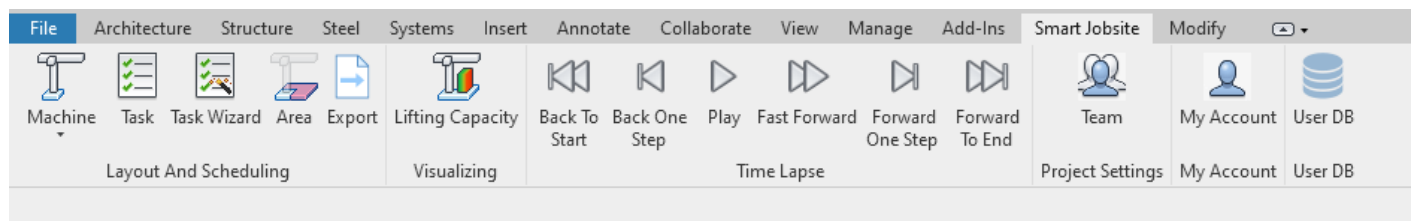

You will have access to the following panel

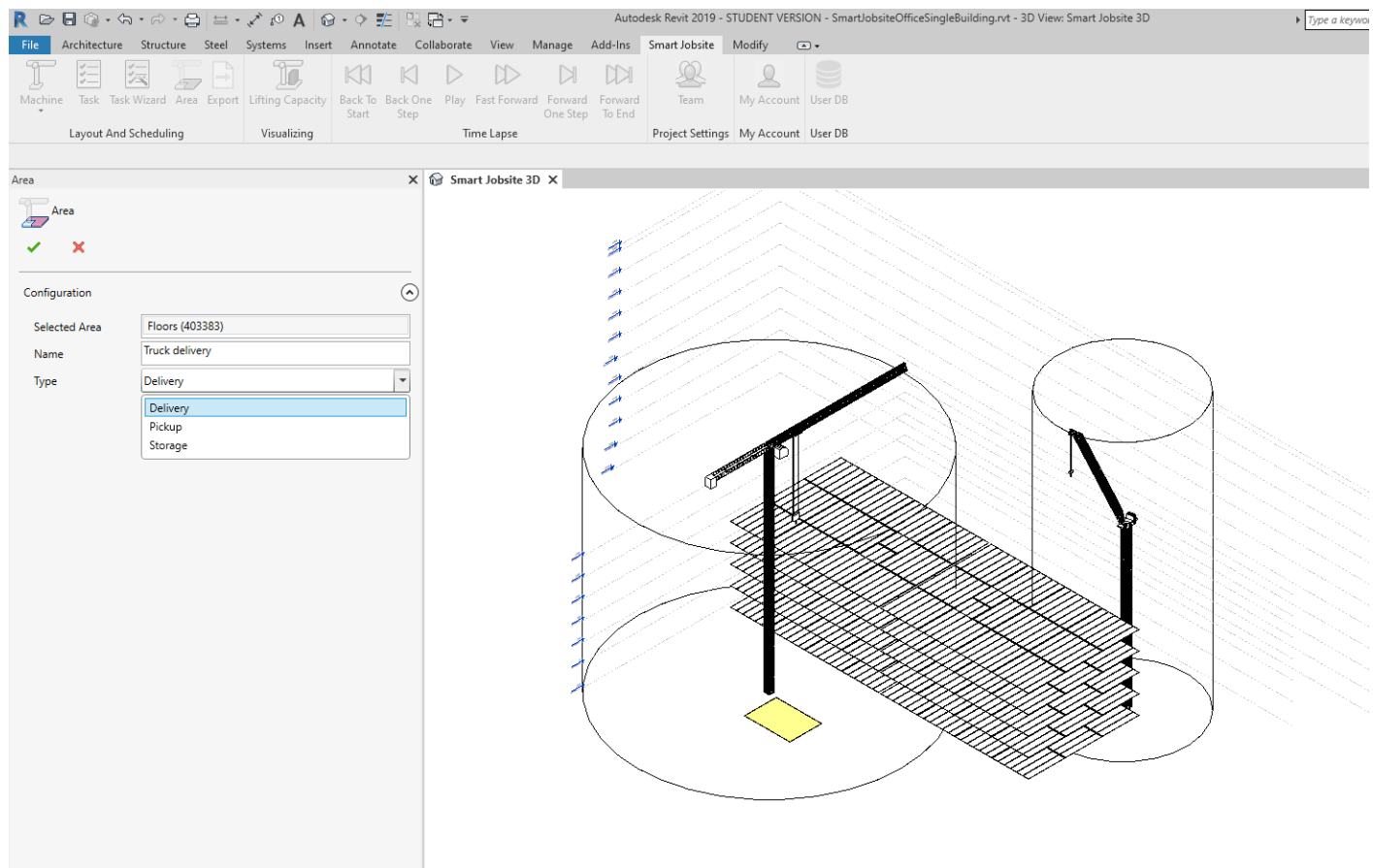

- Selected Area : you can click on a floor on the 3D to select an area
- Name : name of the area
- Type : Type of the area

Then you can validate with



You will see the created area on your schedule

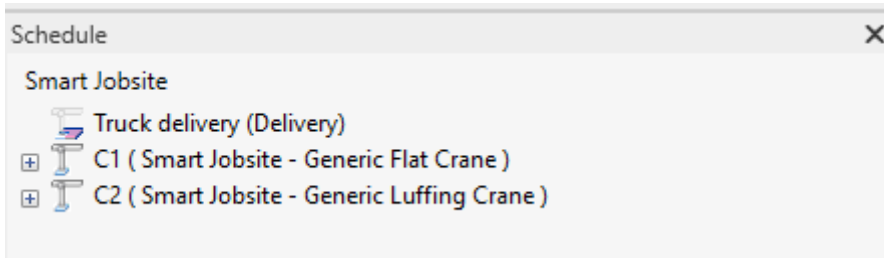

You can change the name of the area by clicking on it

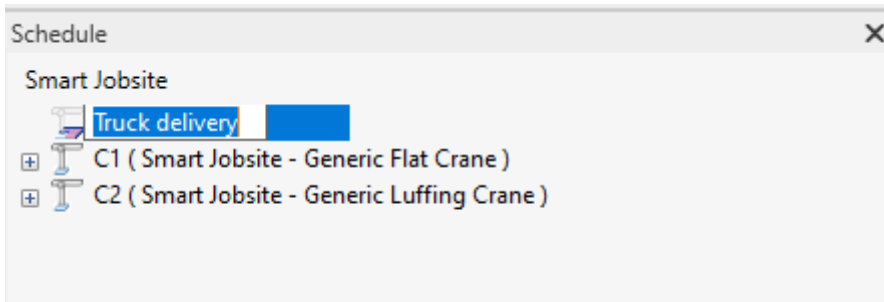

Or right click on it to edit /delete the area

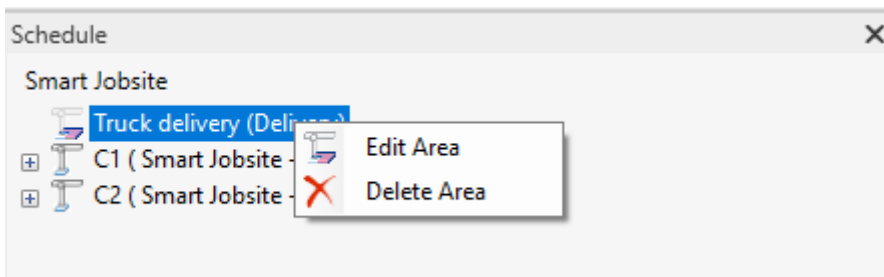

Revision #2

Created 1 December 2020 21:53:47 by Kevin

Updated 1 December 2020 22:08:46 by Kevin