

Task wizard

How to use the task wizard with Smart Jobsite For Revit

The task wizard can be used to create multiple tasks at the same time. You will have access to several filters like level or family. The best practices are to use the filter to create task as the building will be build

Under the Smart Jobsite tab you can click on the "Task Wizard" button

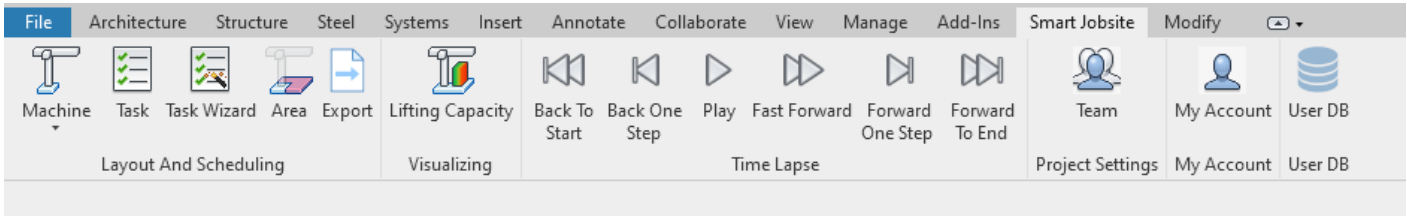

You will have access to the following panel

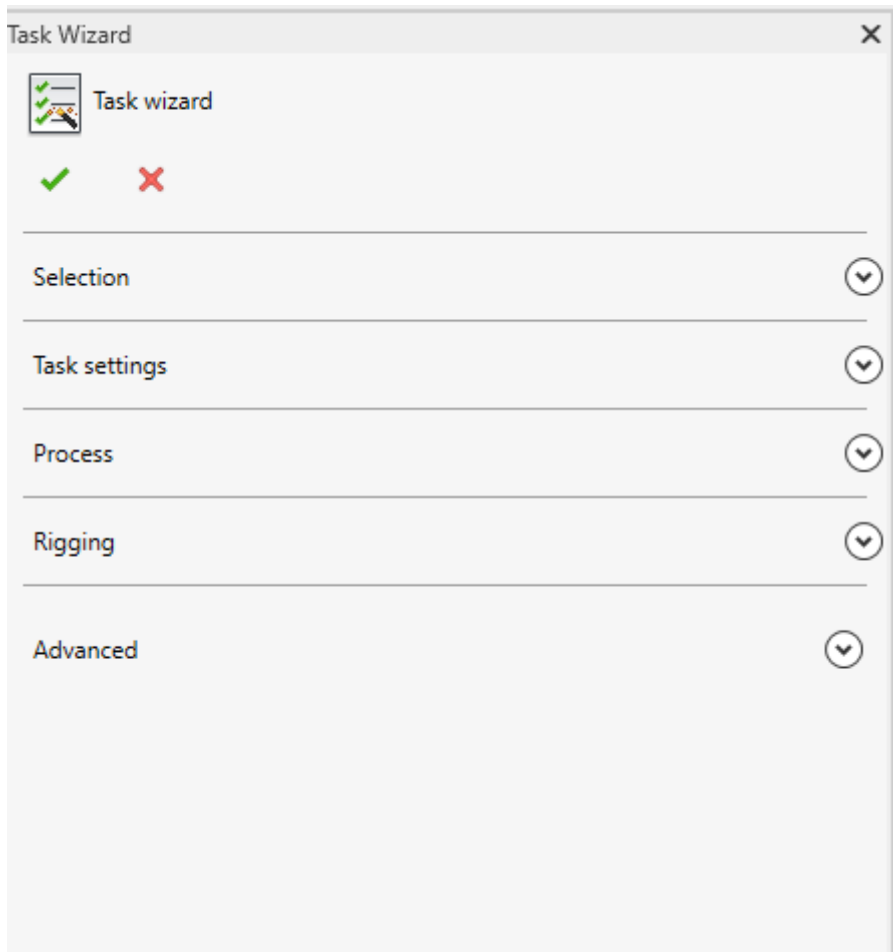

Under selection :

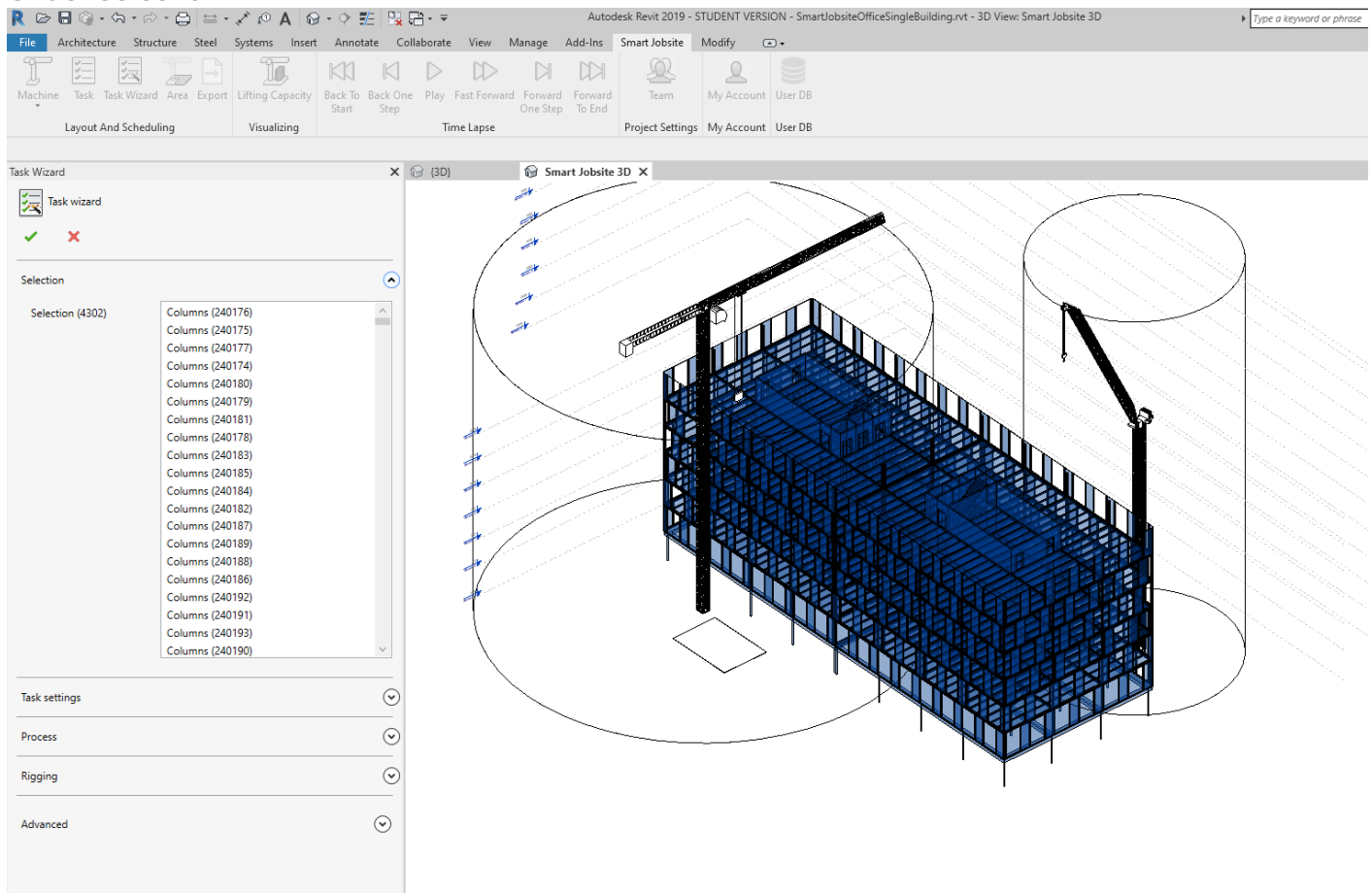

You will see the list of the selected elements. The task wizard will create a task by selected element.

You can right click on the selection to remove elements

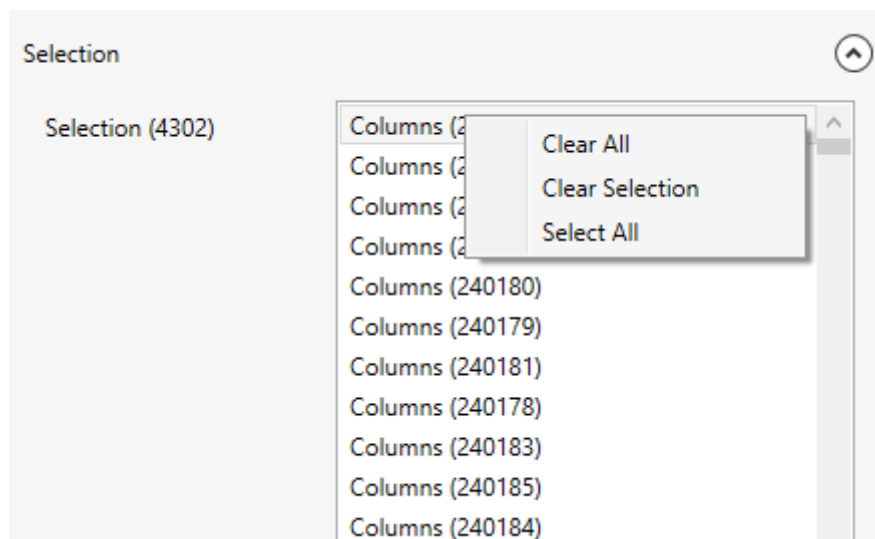

Under task settings :

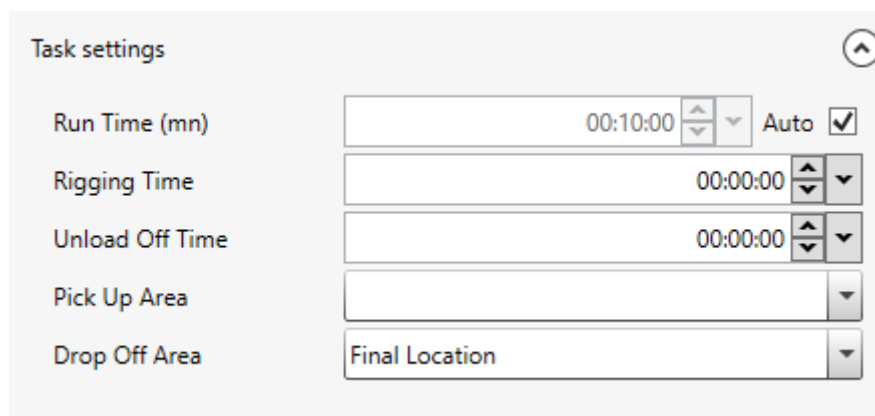

You can manage the settings of the tasks you will create. For more informations about the settings you can go to the Task documentation ([click here to go to the documentation](#)).

Under rigging :



You can manage the rigging type of the tasks you will create. For more informations about the rigging type you can go to the Task documentation ([click here to go to the documentation](#)).

Under Advanced :

Advanced ⬆

Level ☐

Family ☐

Only unassigned elements ☒

Name Field

QR Code Field

You will be able to use several filter

- Level : By checking level you will be able to filter the visible elements by level
- Family : By checking family you will be able to filter the visible elements by family
- Only unassigned elements : By checking/unchecking this option you will be able to hide/unhide the elements that has already been assigned to a task.

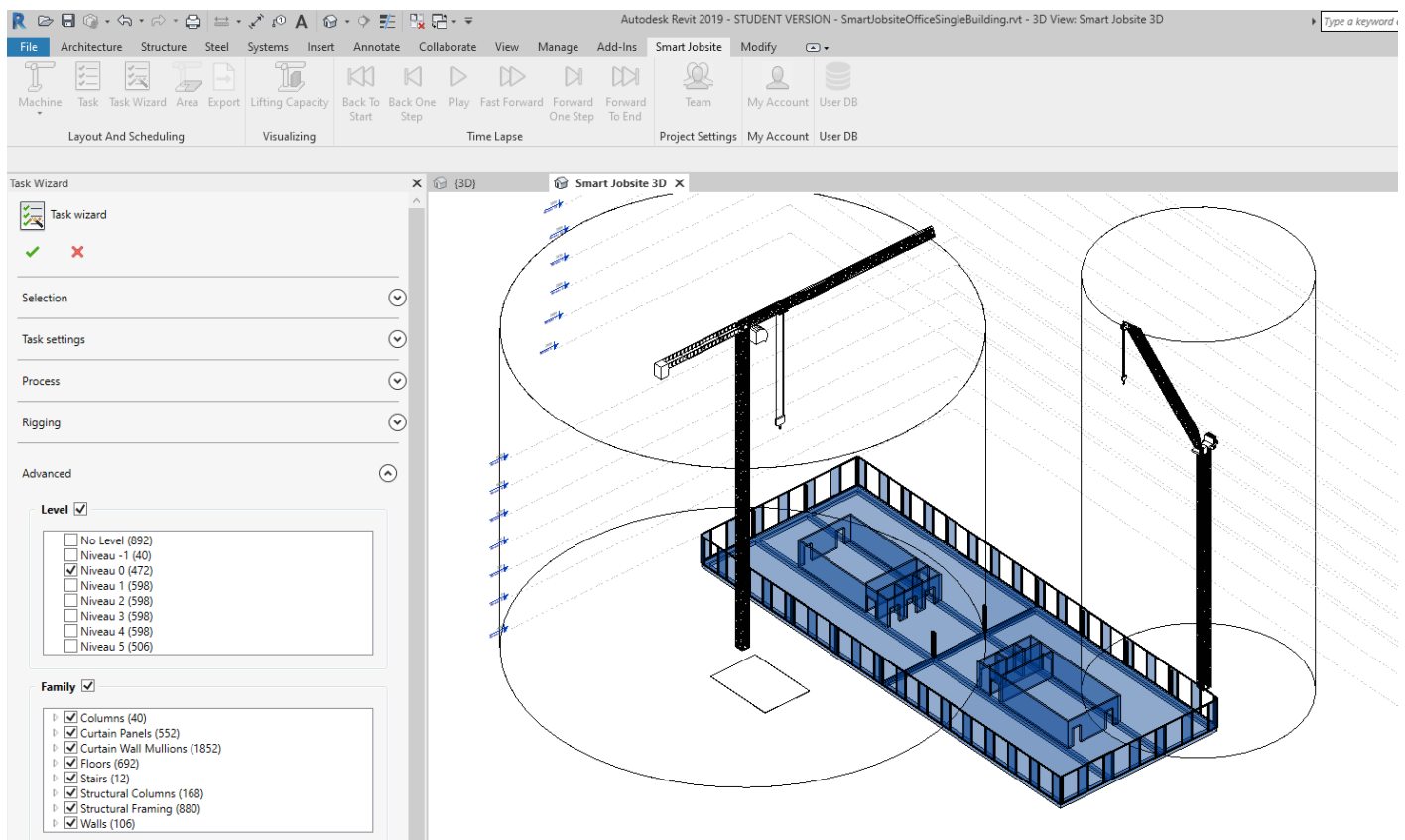

Once everything is setup you can validate by clicking on 

You will see the created tasks on your schedule

Schedule				
Smart Jobsite				
Truck Delivery (Delivery)				
C1 (Smart Jobsite - Generic Flat Crane)				
+	WO 00001	12/01/2020 08:00:00	(36s)	
+	WO 00002	12/01/2020 08:00:36	(38s)	
+	WO 00003	12/01/2020 08:01:14	(43s)	
+	WO 00004	12/01/2020 08:01:57	(Out of Reach)	
+	WO 00005	12/01/2020 08:01:57	(31s)	
+	WO 00006	12/01/2020 08:02:28	(37s)	
+	WO 00007	12/01/2020 08:03:05	(44s)	
+	WO 00008	12/01/2020 08:03:49	(Out of Reach)	
+	WO 00009	12/01/2020 08:03:49	(23s)	
+	WO 00010	12/01/2020 08:04:12	(35s)	
+	WO 00011	12/01/2020 08:04:47	(33s)	
+	WO 00012	12/01/2020 08:05:20	(Out of Reach)	
+	WO 00013	12/01/2020 08:05:20	(31s)	
+	WO 00014	12/01/2020 08:05:51	(44s)	
+	WO 00015	12/01/2020 08:06:35	(40s)	
+	WO 00016	12/01/2020 08:07:15	(Out of Reach)	
+	WO 00017	12/01/2020 08:07:15	(36s)	
+	WO 00019	12/01/2020 08:07:51	(39s)	
+	WO 00021	12/01/2020 08:08:30	(39s)	
+	WO 00023	12/01/2020 08:09:09	(39s)	
+	WO 00026	12/01/2020 08:09:48	(37s)	
+	WO 00041	12/01/2020 08:10:25	(39s)	
+	WO 00042	12/01/2020 08:11:04	(44s)	
+	WO 00043	12/01/2020 08:11:48	(32s)	
+	WO 00044	12/01/2020 08:12:20	(41s)	
+	WO 00045	12/01/2020 08:13:01	(41s)	
+	WO 00046	12/01/2020 08:13:42	(41s)	
+	WO 00051	12/01/2020 08:14:23	(43s)	
+	WO 00053	12/01/2020 08:15:06	(45s)	
+	WO 00054	12/01/2020 08:15:51	(32s)	
+	WO 00055	12/01/2020 08:16:23	(32s)	
+	WO 00056	12/01/2020 08:16:55	(32s)	
+	WO 00057	12/01/2020 08:17:27	(32s)	
+	WO 00058	12/01/2020 08:17:59	(31s)	
+	WO 00059	12/01/2020 08:18:30	(31s)	
+	WO 00060	12/01/2020 08:19:01	(31s)	
+	WO 00061	12/01/2020 08:19:32	(Out of Reach)	
+	WO 00062	12/01/2020 08:19:32	(Out of Reach)	
+	WO 00063	12/01/2020 08:19:32	(Out of Reach)	

Revision #1

Created 1 December 2020 21:30:59 by Kevin

Updated 1 December 2020 21:49:07 by Kevin